

DEVICE SCHEDULE

SERVICE NUMBER	DEVICE NUMBER	DEVICE LOCATION	DEVICE DESCRIPTION	DEVICE SIZE	DEVICE MODEL	QUANTITY REQUIRED	MEASURED LINE PRES	MEASUREMENT DATE / TIME	APPROXIMATE WORST CASE PRES DROP	MAX RELIEF PORT GPM	TOTAL SERVICE GPM	GPM PER DEVICE	NOTES
1	RPZ-1	CELLAR METER ROOM	RPZ BACKFLOW PREVENTER	4"	957-OSY	1	68 PSI	06/26/08 12:30 PM	10	290	400	400	WATTS REGULATOR
2	DCDA-1	CELLAR FIRE PUMP ROOM	DOUBLE-CHECK DETECTOR ASSEMBLY	6"	757-DCDA-OSY	1	68 PSI	06/26/08 12:30 PM	N/A	N/A	N/A	N/A	WATTS REGULATOR

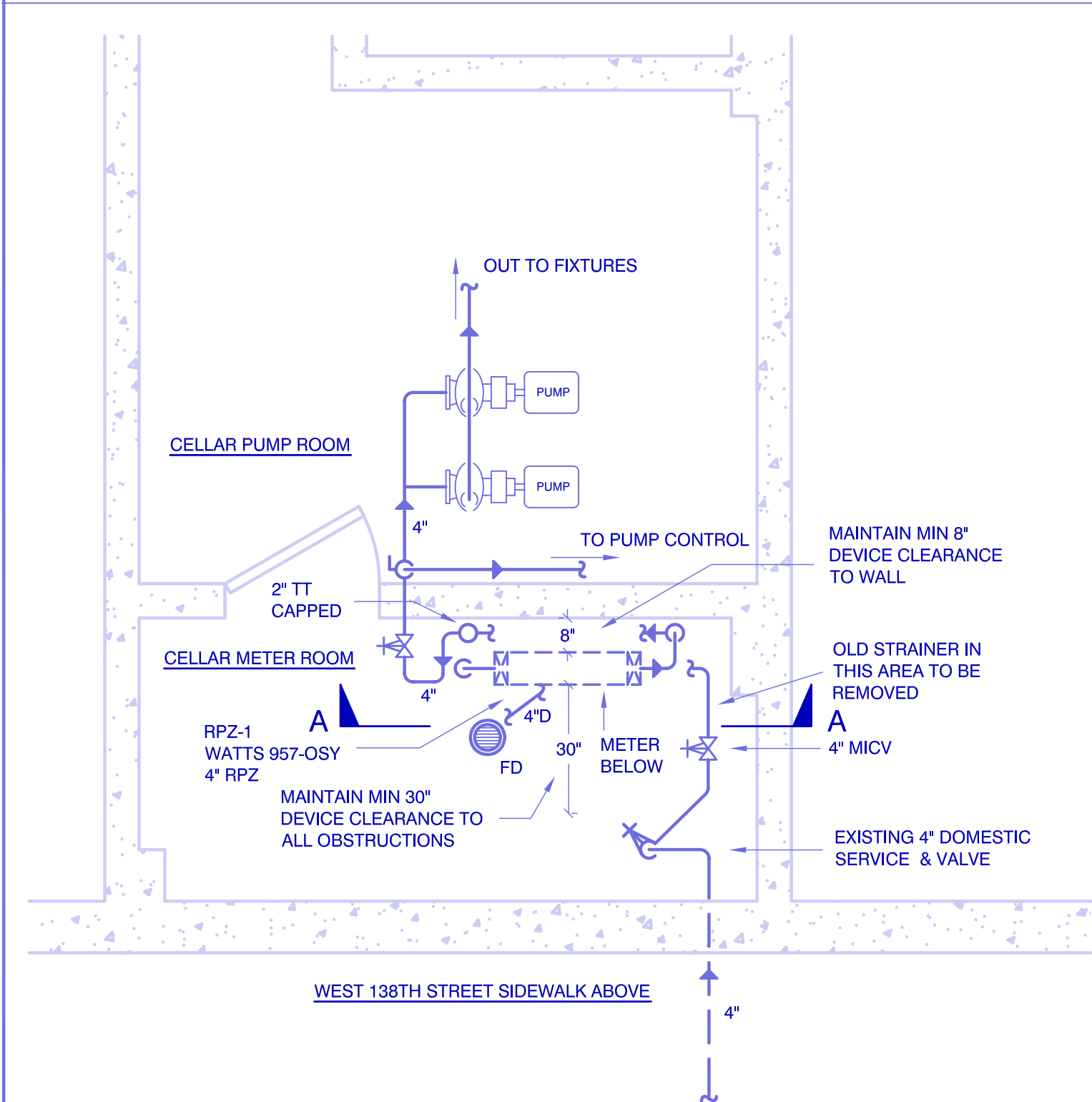

PLAN OF DOMESTIC DEVICE AT CELLAR LEVEL

SCALE 3/8" = 1' - 0"

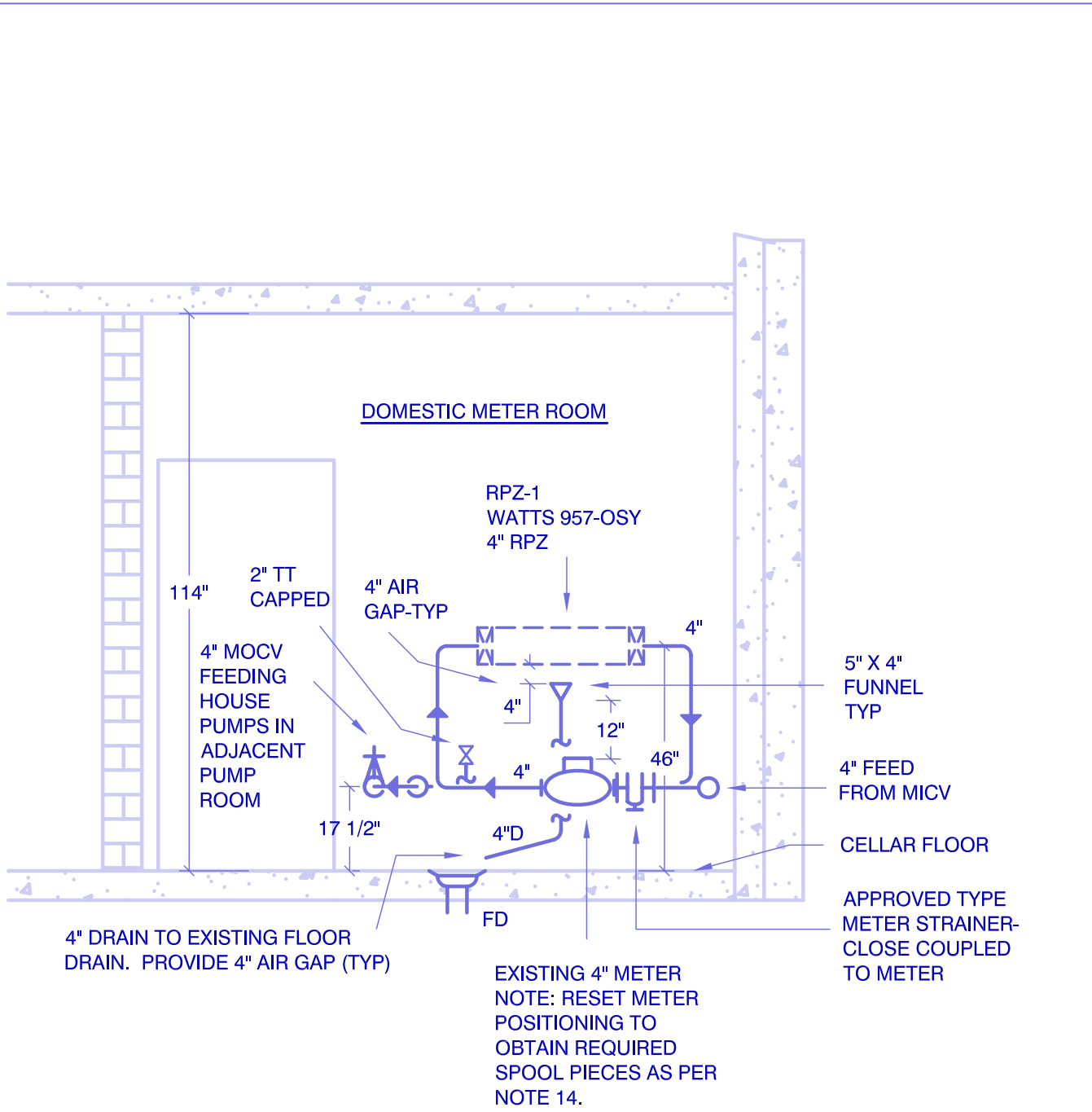

ELEVATION "A - A" DOMESTIC DEVICE

SCALE 3/8" = 1' - 0"

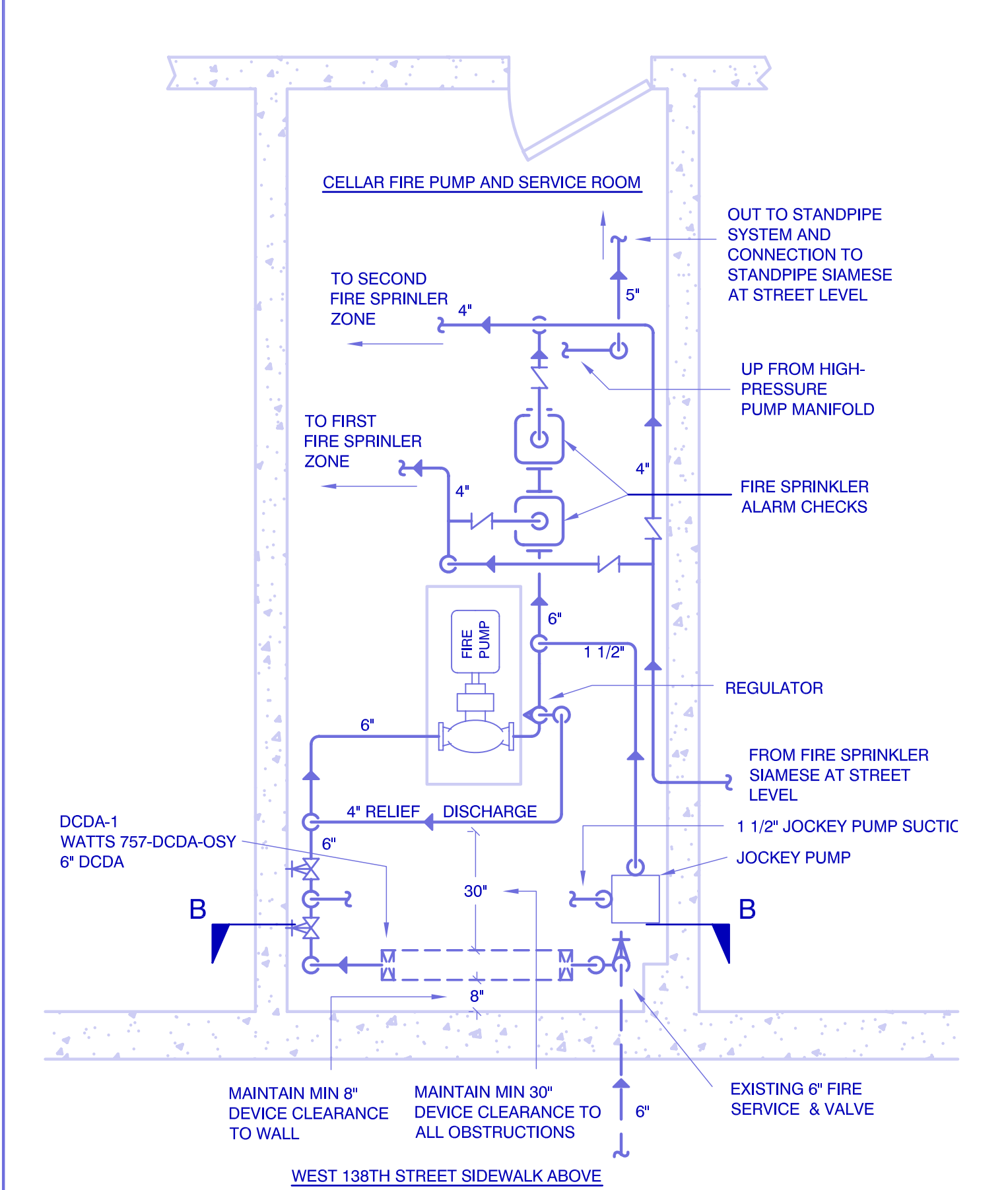

PLAN OF FIRE SERVICE BACKFLOW DEVICE AT CELLAR LEVEL

SCALE 3/8" = 1' - 0"

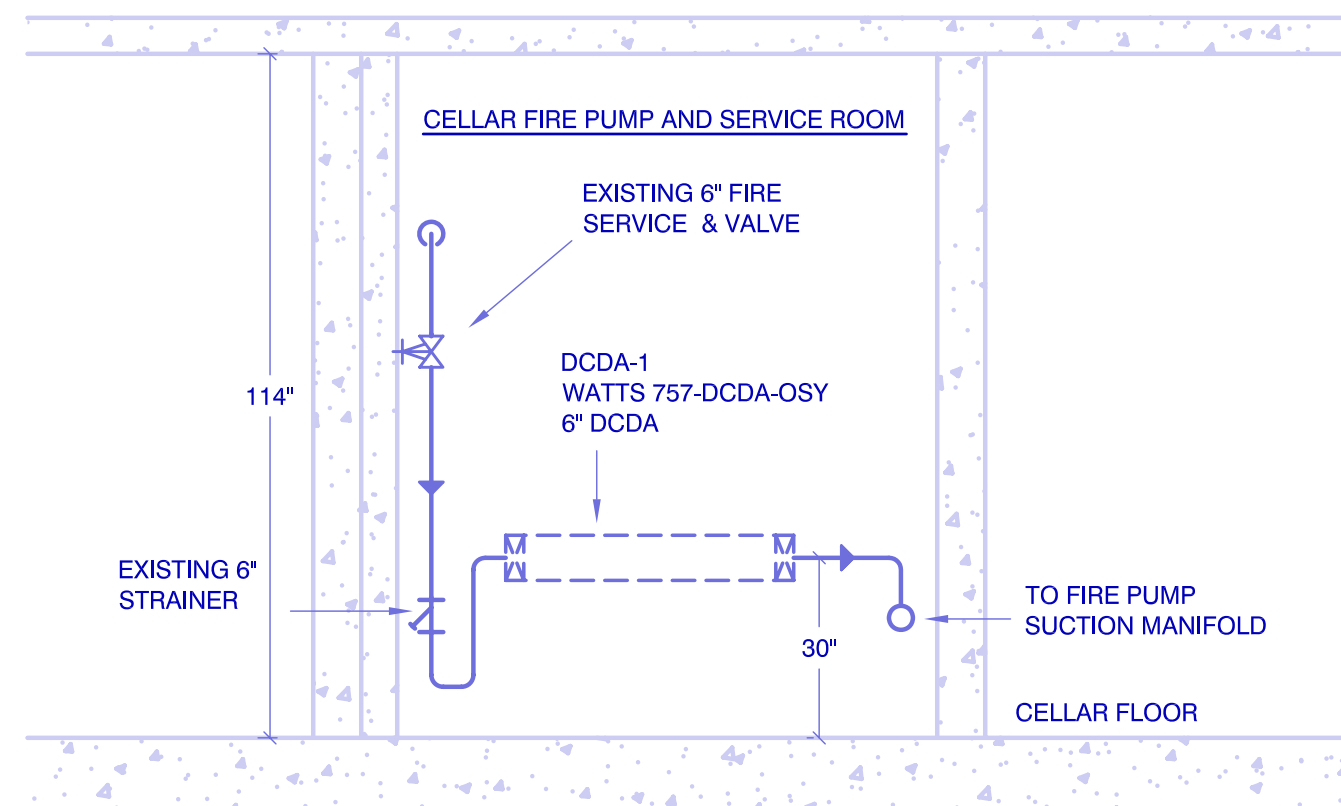

ELEVATION "B - B" FIRE SERVICE DEVICE

SCALE 3/8" = 1' - 0"

30 WEST 138TH STREET, NYC					
Area name	Area (ft. sq.)	Height below relief	H (ft)	Vol (cu.ft.)	Note
Cellar-ENTIRE	16856	39	3.25	54,782.00	
		6	0.50	-	Special
		41.5	3.46	-	
		41.5	3.46	-	
Total Area	16856			54,782.00	Total vol
		Dump rate-GPM	Dump rate- GPH	409,769.36	Total gallons
		290	17,400	23.55	Failure time (hrs))

SUBMERSION DATA FOR BELOW GRADE DEVICE

NOTES:

- THE CALCULATED SUBMERSION TIME SIGNIFICANTLY EXCEEDS THE 8 HOUR CRITERION, THEREFORE THE DEVICE IS ACCEPTABLE FOR BELOW GRADE INSTALLATION.
- DOORS ARE UNDER-CUT AND THERE ARE AMPLE PATHWAYS FOR PASSAGE OF WATER BETWEEN AREAS OF CELLAR.

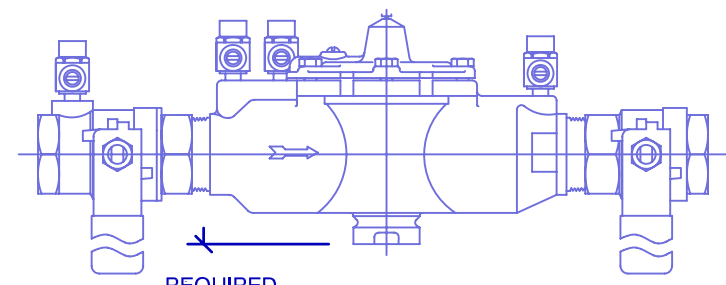

NOTE: A CHECK VALVE MAY BE INSERTED INTO DRAIN LINE WHERE RISK OF BACKDRAFT AND FREEZING COULD OCCUR

FIELD-FABRICATED FUNNEL DRAIN AND DRAINAGE PIPE ASSEMBLY. PROVIDE REQUIRED SUPPORT TO MAINTAIN REQUIRED AIR GAP. DO NOT USE DEVICE MANUFACTURER'S AIR GAP ASSEMBLY.

DETAIL OF FUNNEL DRAIN ASSEMBLY

SCALE = NTS

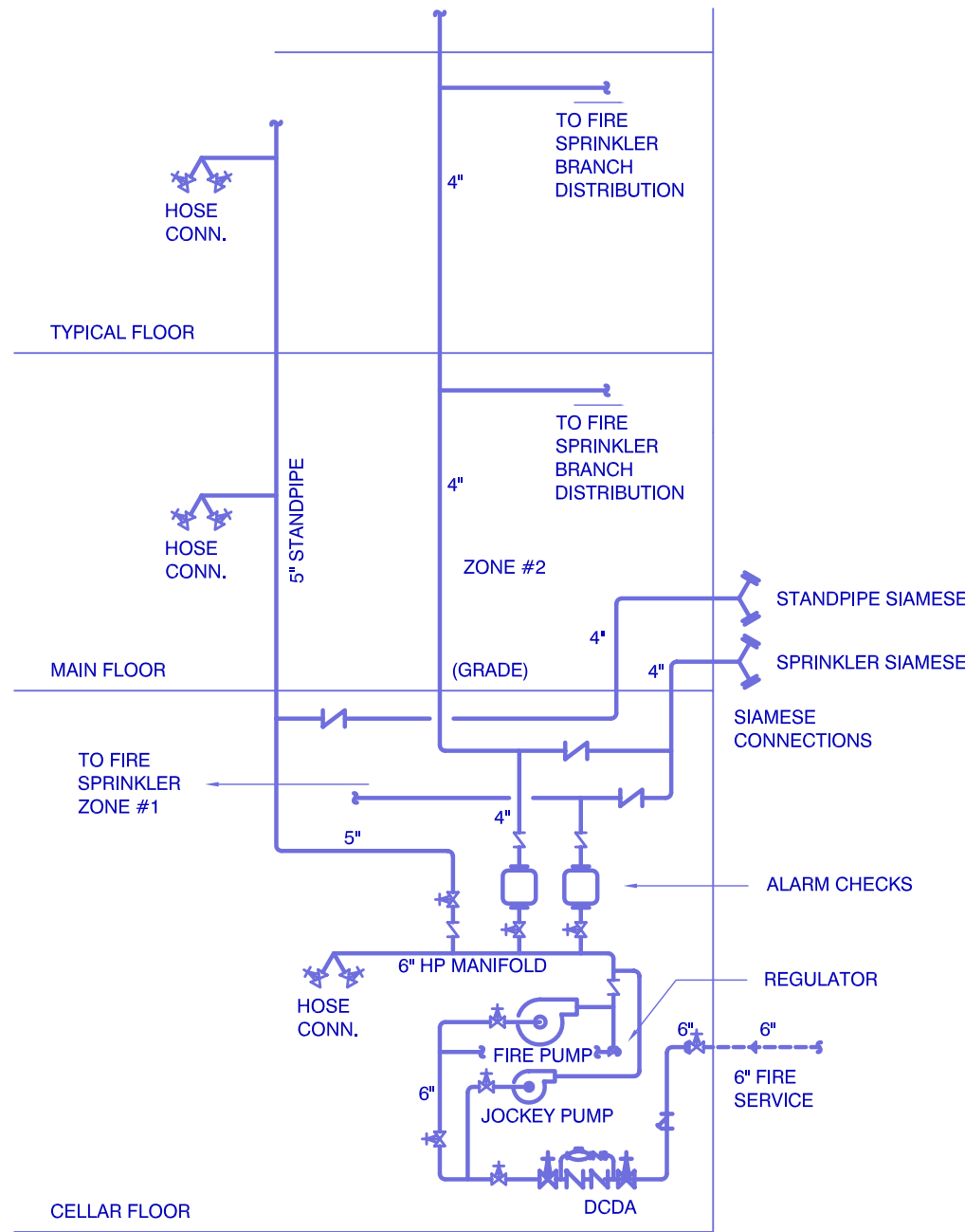

FIRE SYSTEM RISER DIAGRAM

SCALE = NTS

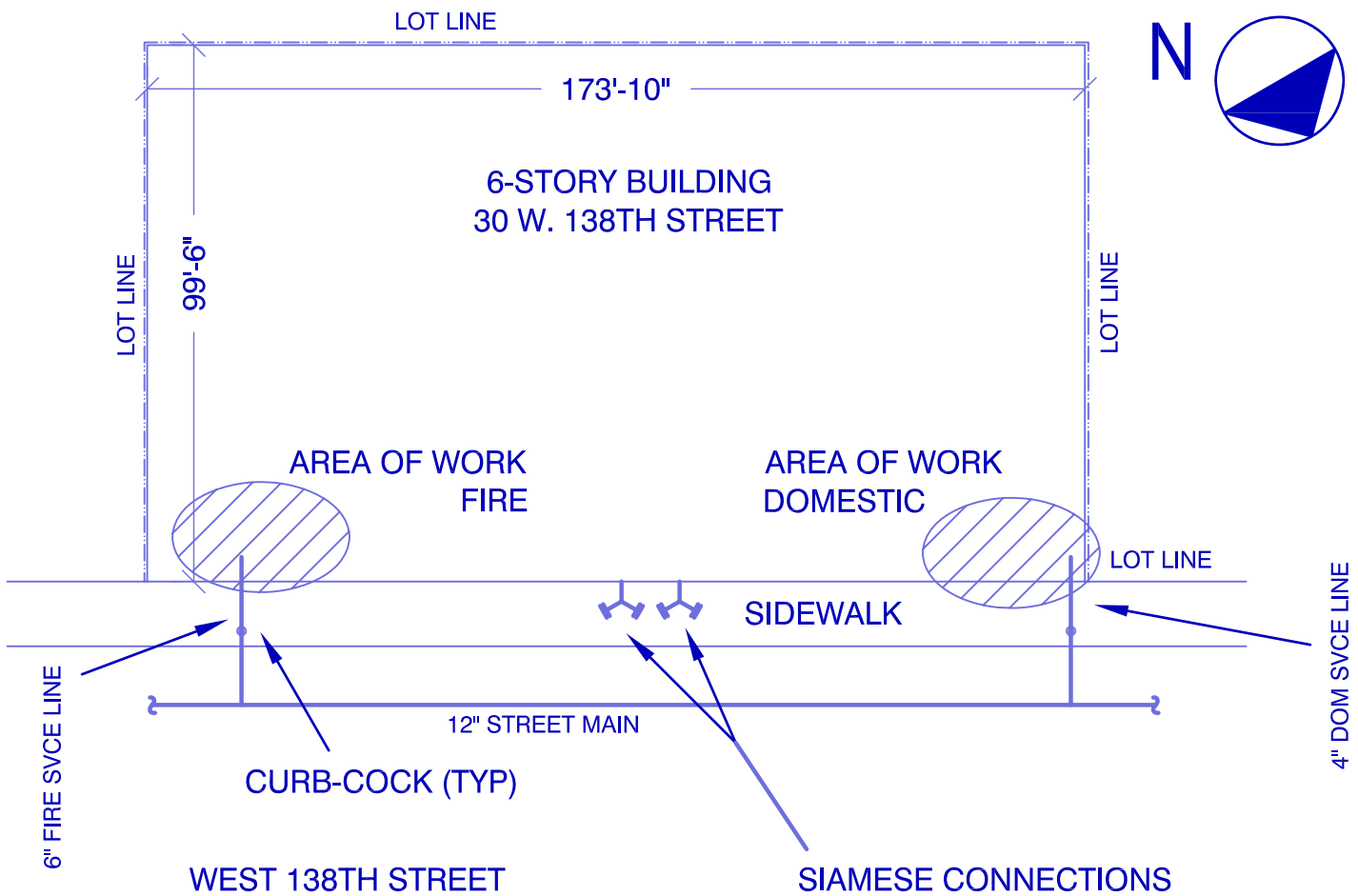

SITE PLAN

SCALE = NTS

GENERAL NOTES:

- EACH BACKFLOW PREVENTER DEVICE SHALL BE TESTED ANNUALLY, DISASSEMBLED AND OVERHAULED EVERY FIVE YEARS AS REQUIRED BY THE NYS HEALTH DEPARTMENT.
- INSTALLATION OF BACKFLOW PREVENTERS AND ALL ASSOCIATED MATERIALS, WORKMANSHIP, APPARATUS, ETC. SHALL MEET THE REQUIREMENTS OF THE NYC HEALTH DEPARTMENT, NYS HEALTH DEPARTMENT, DEPT. OF BUILDING-NYC, AND THE NYC DEPARTMENT OF ENVIRONMENTAL PROTECTION CROSS-CONNECTION CONTROL UNIT.
- ROOMS WHERE BACKFLOW PREVENTER DEVICES ARE LOCATED SHALL BE HEATED AND LIGHTED AREAS.
- PRIOR TO BIDDING AND/OR COMMENCING ANY BACKFLOW PREVENTER WORK, EACH CONTRACTOR SHALL VISIT THE SITE TO CHECK THE AREA OF THE INSTALLATION AND BE RESPONSIBLE FOR SAME.
- INTERMITTENT DRAINAGE DUMPING FROM BACKFLOW PREVENTER RELIEF PORT SHALL BE PIPED TO THE ATMOSPHERE, I.E. NEAREST FLOOR DRAIN, TRENCH DRAIN, SCREENED-OUTLET 12" MIN. ABOVE GRADE OR OTHER SUITABLE AND APPROVED DRAINAGE POINT.
- A LICENSED PROFESSIONAL ENGINEER SHALL BE RESPONSIBLE FOR CHECKING THAT THE DEVICE IS INSTALLED ACCORDING TO THE APPROVED PLAN BY SUBMITTING THE CERTIFICATION STATEMENT ON FORM GEN. 215B. UPON COMPLETION THE DEVICE SHALL BE TESTED BY AN INDIVIDUAL CERTIFIED BY NYS.
- THE DOMESTIC SERVICE SHALL BE PROVIDED WITH A REDUCED PRESSURE PRINCIPLE BACKFLOW PREVENTER DEVICE- AS APPLICABLE SEE SCHEDULE.
- THE FIRE SERVICE SHALL BE PROVIDED WITH A DOUBLE-CHECK DETECTOR ASSEMBLY PRINCIPLE BACKFLOW PREVENTER DEVICE- AS APPLICABLE SEE SCHEDULE.
- THE CONTRACTOR SHALL PROVIDE THE STENCILED MESSAGE "FEED TO BACKFLOW PREVENTER - DO NOT TAP OR CONNECT TO THIS LINE". LETTERING SHALL BE 1" HIGH BLACK LETTERS ON A WHITE BACKGROUND AT 5 FOOT INTERVALS BETWEEN THE BACKFLOW PREVENTER AND THE WATER METER.
- WHEN A CURB VALVE SHUTDOWN IS REQUIRED, THE CONTRACTOR SHALL MAKE ALL NECESSARY ARRANGEMENTS WITH THE WATER UTILITY AND PAY ANY FEES THAT MAY BE REQUIRED.
- THE FACILITY AFFECTED BY ANY SHUTDOWN SHALL BE GIVEN AT LEAST 72 HOURS ADVANCE NOTICE AND AGREE TO A COORDINATED SHUTDOWN PROCEDURE.
- ALL REQUIRED CUTTING, PATCHING, CONCRETE PADS, PIPE STANDS AND SUPPORTS, AND OTHER APPURTENANCES TO BE PROVIDED BY THE INSTALLING CONTRACTOR.
- THE INSTALLING CONTRACTOR SHALL HIRE ANY SUBCONTRACTORS REQUIRED FOR THE SUCCESSFUL COMPLETION OF ALL PHASES OF THE PROJECT AND BE RESPONSIBLE FOR SAME.
- FOR WATER METERS LARGER THAN 2", A METER INLET CONTROL VALVE SHALL BE PROVIDED BETWEEN THE HOUSE VALVE AND THE METER. THERE SHALL BE A SPOOL PIECE UPSTREAM OF THE METER (AND STRAINER IF APPLICABLE) OF NOT LESS THAN 5 PIPE-DIAMETERS, AND A SPOOL PIECE OF NOT LESS THAN 3 PIPE-DIAMETERS DOWNSTREAM OF THE METER (AND BEFORE ANY BACKFLOW PREVENTER DEVICE).

NEW YORK CITY BUILDING DEPARTMENT NOTES:

ALL WORK SHALL COMPLY WITH THE APPLICABLE SECTIONS OF THE BUILDING CODE OF THE CITY OF NEW YORK DATED DECEMBER 6, 1968, AMENDED DEC 1,1991 OR AS FURTHER AMENDED.

CONTRACTOR RESPONSIBILITIES

RUN ALL PLUMBING DOMESTIC WATER, FIRE-SPRINKLER LINES AND DRAINAGE PIPING PROPERLY FASTENED USING PROVEN SECURING TECHNIQUES.  
INSTALL ANY STEELWORK OR FRAMES REQUIRED TO STABILIZE AND SUPPORT THE BACKFLOW PREVENTER DEVICES, METERS AND ACCESSORY EQUIPMENT.  
PAY FOR, FILE, AND OBTAIN ANY AND ALL PERMITS REQUIRED FOR THE PROJECT.

TENANT SAFETY NOTES

- ALL WORK SHALL COMPLY WITH THE RULES AND REGULATIONS OF THE CITY OF NEW YORK BUILDING DEPARTMENT.
- CONSTRUCTION SHALL BE LIMITED TO NORMAL WORKING HOURS, MONDAY THROUGH FRIDAY, 8 AM TO 4 PM, EXCEPT LEGAL HOLIDAYS UNLESS OTHER ARRANGEMENTS ARE MADE IN ADVANCE WITH FACILITY.
- TWO FULLY CHARGED AND OPERABLE FIRE EXTINGUISHERS SHALL BE PROVIDED BY THE CONTRACTOR AND MADE READILY ACCESSIBLE AT ALL TIMES.
- CONSTRUCTION SHALL NOT BLOCK HALLWAYS OR OTHER MEANS OF EGRESS.
- CONSTRUCTION AREAS SHALL BE KEPT AS DUST-FREE AND CLEAN AS POSSIBLE.

PLOT DATA

BLOCK: 1735	LOT: 47	COUNTY: NEW YORK
-------------	---------	------------------

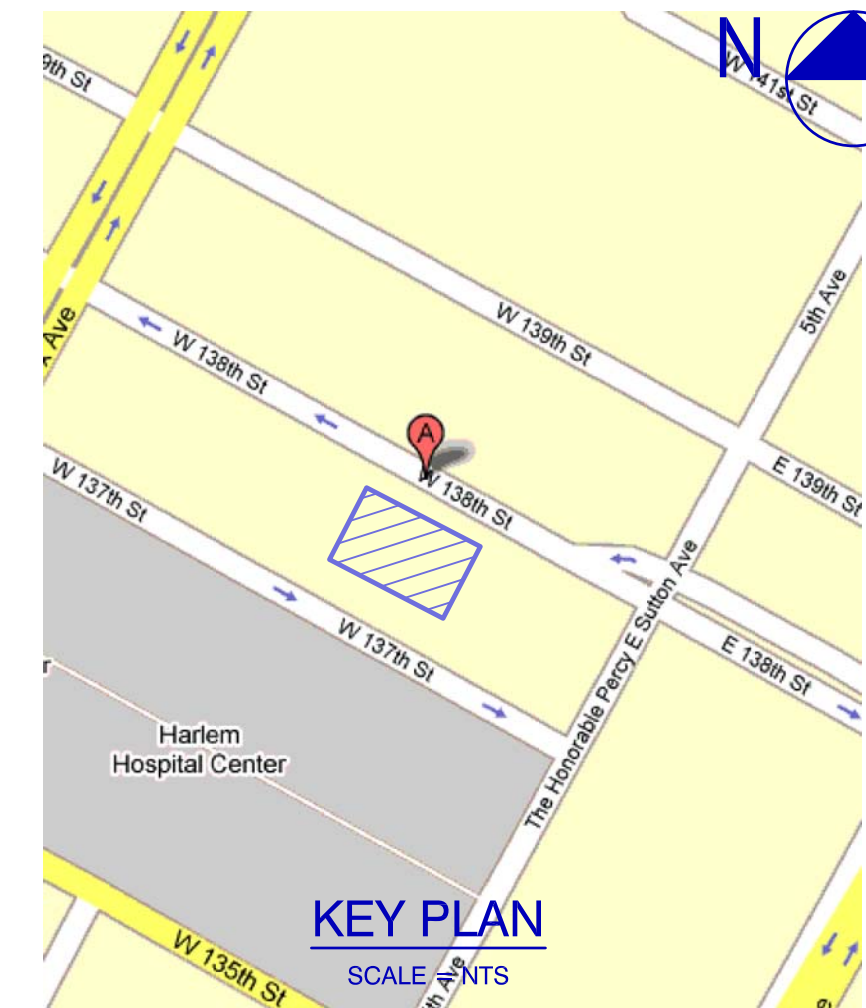

NOTICE: It is a violation of the laws of the State of New York for any person, unless acting under the direction of a licensed professional engineer, to alter this document in any way. If this item is altered, the seal of the altering engineer shall be affixed to some with the notation "altered by" followed by the individual's signature, date and description of such alteration.

THIS PLAN IS APPROVED ONLY FOR THE WORK INDICATED ON THE APPLICATION SPECIFICATION. ALL OTHER MATTERS SHOWN ARE NOT TO BE RELIED UPON, OR TO BE CONSIDERED AS EITHER BEING APPROVED OR IN ACCORDANCE WITH APPLICABLE CODES.

SYMBOL LIST

VALVES

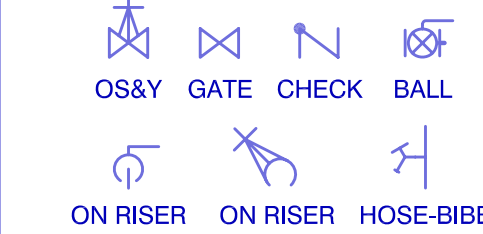

METER VIEWS

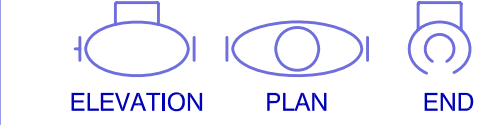

BACKFLOW DEVICES

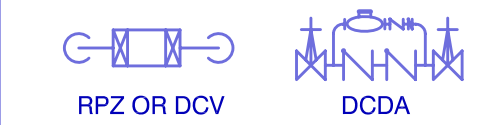

MISCELLANEOUS

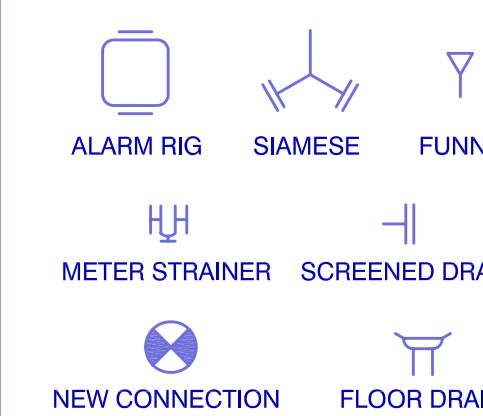

TERMINOLOGY

MOCV	METER OULET CONTROL VALVE
MICV	METER INLET CONTROL VALVE
TT	TEST TEE- CAPPED
AFF	ABOVE FINISHED FLOOR
(E)	EXISTING
(N)	NEW
(R)	REMOVE

00/00/00	Not applicable
Date	Revision



Project  
GREATER HARLEM NURSING HOME  
30 WEST 138TH STREET  
NEW YORK NY 10037

Drawing Description

BACKFLOW  
PREVENTER  
PROJECT

Date	08/04/08	Sheet/Dwg No.
Draw by	GLS	P-1
Project No.	GLS-PE-192	
Scale	AS NOTED	